



Teal Big Sink®

The most versatile portable sink ever.

- Hot and cold running water
- For building site Welfare
- Outside Catering
- Food Preparation
- Utensil wash
- Arm washing

The Best Hot
Water Hand Wash
in the World

Just needing a 10 amp 230V socket for operation, the Big Sink® BS230 is completely self-contained with the waste water secured in a separate cleanable container.

Big Sink® can be used on a table or counter top and is delivered complete with a collapsible stand and 2 off 25litre water containers. The unique TEAL low pressure spray ensures effective water use** and ideal hand coverage with no splashing.

- Hot and cold water
- Red nudge button for an ideal 10 SE COND hot wash
- Instantaneously heated hot water – approx. 40°C
- Enjoy up to 125 ten second hot washes per filling
- Blue On/Off button for cold/ambient water
- Unique TEAL spray head gives ideal water coverage
- Nothing to adjust – factory set and tested
- Light weight and uniquely portable.

Pivoting swan neck tap removable for packing.

Hygiene assured by use of the simple disinfection routine.

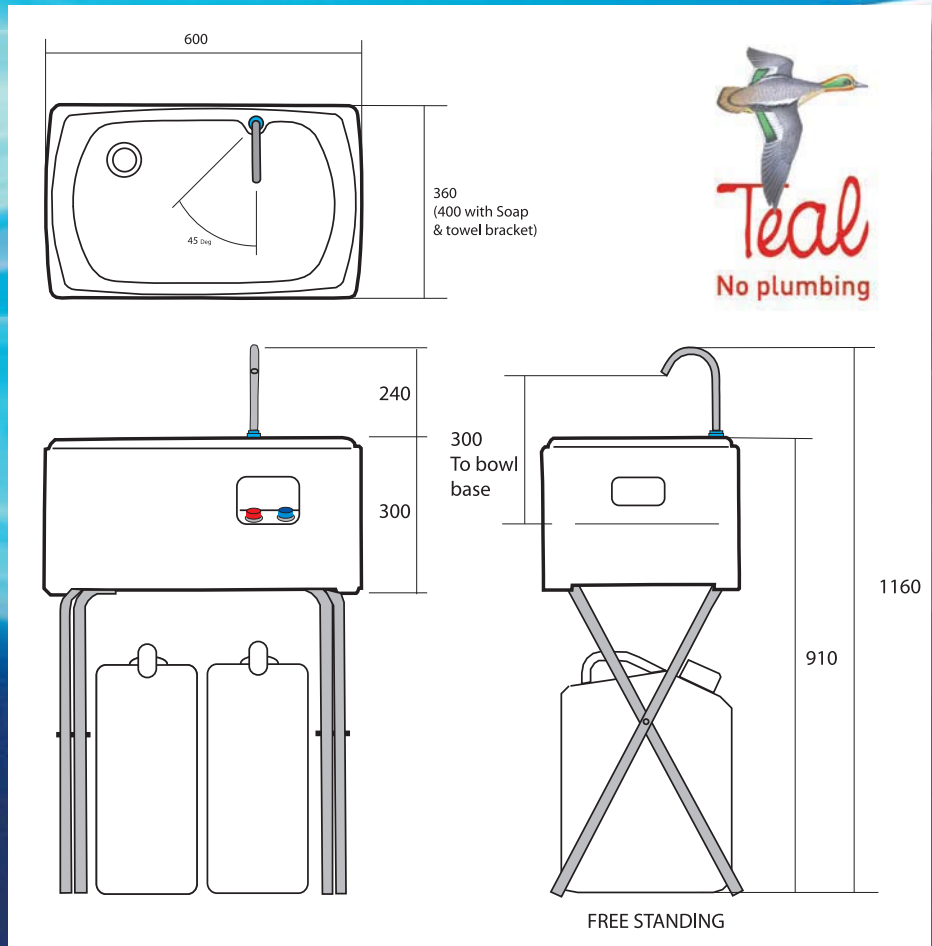

Specification

- Body and bowl moulded in Acrylic capped high impact ABS
- 2 metre power lead with moulded 10 amp plug
- Collapsible powder coated steel tube stand

Power

10 amp at 230 VAC 2.4kW

Extras available

- Bracket for paper towels
- Liquid soap dispenser and bracket
- Foot switch for 'Hands Free' hot washing. BSFS



**Big Sink® BS230 is an Environmentally Friendly design using Less water and Less energy than all other types of conventional plumbed in sinks.

Manufacturer reserves the right to subject the product to change without notice (Meets EMC regulations).

Big Sink® is Registered Design

For more information

www.modulstor.ro

Modul-Stor Hungary Kft.
8200 Veszprém, Hungary

Tel: +4-0745-554786

E-mail: atelieremobile@yahoo.com

The Best Hot Water Hand Wash in the World